



Elizabeth Bridge Reserve

MASTER PLAN

Adopted September 2020



We acknowledge and respect Traditional Owners across Australia as the original custodians of our land and waters, their unique ability to care for country and deep spiritual connection to it. We honour Elders past, present and emerging whose knowledge and wisdom has and will ensure the continuation of cultures and traditional practices.

ACKNOWLEDGMENT OF COUNTRY

Content

1	INTRODUCTION.....	4
2	EXISTING CONDITIONS	5
3	MASTER PLAN.....	6
	Precinct Plan.....	8
4	MASTER PLAN IMPLEMENTATION.....	9
	General Improvements.....	9
	Precinct 1: Western Activity Area and Main Entry	10
	Precinct 2: Eastern Activity Area.....	12
	Precinct 3: Northern Activity Area	13
	APPENDIX	



Introduction

Purpose

Elizabeth Bridge Reserve is a valuable community recreational centre providing a wide range of formal and informal recreational uses.

This Master Plan aims to provide a comprehensive analysis and guidance for the future planning and programming of the Reserve to better accommodate its existing users, as well as providing opportunities for additional activities and uses.

Context and History

Elizabeth Bridge Reserve is located in Kilsyth over an area of roughly 9.6 hectares. The site is separated into two distinct activity areas with the northern oval providing facilities for more formulated activities such as football and cricket, and the southern portion accommodating a wider range of low intensity/passive recreational opportunities.

The Department of Education and Training manage the former school site to the north of the Reserve and lease the oval area to Council.

The Friends of Elizabeth Bridge Reserve have been operating for over 13 years actively being involved in working bees on the first Sunday of every month (except January). These have seen the planting of a number of new species and keep the reserve looking well manicured.

The wetland is currently managed by Melbourne Water.

Background Assessment

A extensive series of background studies and assessments were conducted as part of the master planning processes, including the review of the following:

- Zoning;
- Overlays;
- Yarra Ranges Council Plan 2017-2021;
- Yarra Ranges Community Safety Plan and Action Plan 2014-2018;
- Equity, Access and Inclusion Strategy 2013- 2023.
- Environment Strategy 2015-2015;
- Recreation and Open Space Strategy 2013-2023;
- Integrated Water Management Plan 2017;
- Integrated Transport Strategy;
- Health and Wellbeing Strategy 2017-2021;
- Playspace Plan 2019-2029;
- Child and Youth Strategy 2014-2024;
- Connecting Young People - Strategic Action Plan 2016-2029;
- Yarra Ranges Reconciliation Framework for Action 2013-2023.

Consultation

The local community and stakeholder groups were

engaged to seek insight into their wants, needs and general perception of Elizabeth Bridge Reserve and to identify the key features and characteristics considered valuable to them.

The initial consultation process for the Elizabeth Bridge Reserve Master Plan took place from September to November 2019 (194 responses), with further consultation undertaken in mid-2020 following public release of the draft Master Plan (74 responses).

Consultation review with key stakeholders, Council's Project Reference Group, representatives from Kilsyth Community Action Group and Friends of Elizabeth Bridge Reserve was undertaken in August 2020. This enabled a review of community feedback and to confirm that the draft Master Plan responded to the key issues and opportunities as identified during the early stages of the project. Consultation throughout the project covered a number of formats as listed below:

- Council internal workshops;
- Local user group and stakeholder engagement sessions;
- Briefings with the Kilsyth Community Action Group & Friends of Elizabeth Bridge Reserve;
- (2) Community drop-in session on site in 2019;
- Direct mailing and online surveys.

A summary of the results can be found in the Elizabeth Bridge Reserve Background Report.

Existing Conditions



figure 1 Existing site aerial (NTS)

Master Plan

LEGEND

- | | |
|--------------------------------------------------------------------------------------------------------|-------------------------------------------------------------------------------------------------------------|
|  Existing trees |  Existing rotundas |
|  Proposed trees |  Existing rotundas |
|  Garden bed planting |  Public art opportunities |
|  Lawn |  Picnic table set |
|  Feature paving |  Bus stop |
|  Granitic sand paving |  Fitness station |
|  Concrete paving |  Proposed new toilet block |
|  Softfall |  Existing pathway |
|  Timber decking |  Proposed pathway |



figure 2 Master Plan

Master Plan

- 1 Formalise entry and upgrade the boundary treatment at Beatrice Street to improve the entry experience.
- 2 Additional meandering gravel path through the forest area to provide additional nature and sensory play opportunities and 'Bush Kinder'.
- 3 Upgrading the pedestrian circulation with an additional formal sealed/accessible path connection from the Bridge House to the forest area. An additional sealed path will also be installed connecting the car park area with western activity area.
- 4 Upgrades to the existing picnic/gathering amenities with additional shelter areas with BBQ, and picnic tables around the existing play space. The location of these amenities will also be within close proximity to the drinking fountain, bin and toilet block.
- 5 Refurbish the existing play space in the short term, and progressively improve the play space with additional equipments over the next 10 years. The play space will be upgraded to district level by 2032.
- 6 Provide fitness stations and improved path lighting around the reserve to promote active recreation and to improve user safety
- 7 Wetland:
Upgrade the existing concrete lookout into a board-walk, allowing better interaction with the wetland and promoting the use of natural materials. The board-walk will include barriers and signage to improve safety, particularly with younger children.

Incorporate interpretation/information for wetland.

Review existing bridge access treatments to allow for safe access for all.
- 8 Installation of a new activity precinct just north of the car park area. This precinct will focus on active recreational activities and will include a multi-use half court and a shelter space for outdoor fitness. A new toilet block will also be located along the path intersection to better accommodate level of usage at the Reserve. This space will also be used for community events and gatherings when required.
- 9 New pedestrian entry and expanded car park along the Durham Road frontage. The formalised pedestrian entry will serve to indicate pedestrian priority and remove conflict with vehicles. Improvements will improve accessibility. New entry signage will be installed to include the history of the Reserve. The new car park area (1 way travel) provides additional parking amenity for the users, as well as minimising conflict with vehicles by providing a circulation loop.
- 10 Upgrades to the Bridge House with fresh paint to the building exteriors and the installation of a new sensory garden.
- 11 Additional public art opportunities around the wetland area to provide additional character and amenity for the Reserve. The art works will also function as a visual connection to unify the different activity areas.
- 12 Removal of the existing under utilised amphitheatre to expand the lawn area. A smaller seating/viewing area will be retained adjacent to the existing path to retain the passive recreation opportunities. A larger new large shelter area will be located at the top of the ridge to provide activation and act as a lookout both into the wetland and the dog off-leash areas to the east and west.
- 13 Explore opportunities for additional parking along Durham Road to accommodate larger community and sporting events.
- 14 Provide a dog off-leash area in the existing lawn area at the eastern end of the Reserve extending down the hill to the amphitheatre area to the west.
- 15 Provide a mixture of fencing, timber post treatment and/or barrier planting treatments around the proposed dog park to reduce conflict with pedestrians and vehicles. Incorporate a barrier fence along the southern boundary of the proposed dog off-leash area to provide a safe interface with Durham Road.
- 16 Upgrades to the oval and surrounds including a barrier net behind the southern goal, new drainage, turf, fences, gravel paths, lighting and cricket practice nets.
- 17 New toilet/change facilities to the northern boundary of the oval with emergency and disabled vehicle access.
- 18 Advocate for car park and road access in the future site works to activate the Reserve and associated activity spaces.

Precinct Plan



figure 3 Precinct Plan

1:2000 @ A4

Master Plan Implementation

The total cost to implement the proposed EBR Master Plan over the 10+ years is estimated to be \$5 million. A summary of the recommendations, approximate cost and time frames for each precinct are listed as follow.

The State Government have allocated \$700,000 to the short term initiatives through a recent grant.

General park improvements

Additional to the breakdown of improvement into each of the activity precincts, the Master Plan also recommends an overall improvement to the facilities and amenities within the Reserve, such as the footpaths, general seating, lighting, signage and wayfinding, etc.

LEGEND

Short term	1-3 years
Medium term	4-6 years
Long term	7-10 years

Reference	Recommendations	Estimate Cost	Time Frame	Council/Other Contribution	State Govt. Contribution
-	Improved path lighting to increase sense of security and improve safety.	\$100,000	Short	\$50,000	\$50,000
-	Additional seating to provide additional opportunities for rest, social recreations and admiring the local flora and fauna.	\$15,000	Short	-	\$15,000
-	New proposed public footpath along Durham Road between Japara House crossing and the main entry to Elizabeth Bridge Reserve.	Completed	-	-	-
-	New park signage with interpretive educational information and park maps highlighting the history of the establishment of the reserve plus links to indigenous culture (including other various relevant graphics).	\$125,000	Medium	\$125,000	-
Sub-Total		\$240,000		\$175,000	\$65,000

Precinct 1: Western Activity Area and Main Entry

The Western Activity Area and Main Entry aims to provide opportunities for more family and fitness orientated activities. This precinct includes a playground (to be upgraded to district level over the next 10 years), a new half court, new shelter and picnic facilities, a new toilet block, car park and entry signage into the Reserve.



LEGEND

Short term	1-3 years
Medium term	4-6 years
Long term	7-10 years

Reference	Recommendations	Estimate Cost	Time Frame	Council/Other Contribution	State Govt. Contribution
1	Update residential fencing to boundary at Beatrice Street entry.	\$6,000	Medium	\$6,000	-
2	Provide gravel circuit path and nature play elements to 'forest' area to promote uses for activities such as 'Bush Kinder'.	\$25,000	Medium	\$25,000	-
3	Construct new path from Bridge House path intersection to 'forest' area.	\$13,000	Medium	\$13,000	-
4	Car park extension and modifications.	\$300,000	Short	\$150,000	\$150,000
5	Drinking fountain with dog bowl attachment.	\$13,250	Short	-	\$13,250
6	Fitness equipment and circuit distance markers.	\$120,000	Short	\$70,000	\$50,000
7	Upgrade wetland lookout with decking, seating, signage and safety barrier.	\$85,000	Long	\$85,000	-
8	Interactive water feature.	\$25,000	Long	\$25,000	-
9	Refurbishment to existing play space area.	\$6,000	Short	\$3,000	\$3,000
9	Upgrade existing play space to district level, including accessible play elements	\$568,000	10+ years (2031-2032)	\$568,000	Future Application
10	Additional rubbish bins around the picnic and play space area.	\$5,000	Short	\$5,000	-
11	Additional picnic tables and seating areas.	\$7,500	Short	\$3,000	\$4,500
11	Additional picnic shelter including tables sets and BBQ to play space surrounds (including upgrades to the existing picnic shelters to match).	\$80,000	Medium	\$80,000	-
12	Construct new toilets block at main entry.	\$250,000	Medium	\$250,000	-
13	Construct a new shelter space for outdoor fitness and events.	\$100,000	Medium	\$100,000	-
13	Construct new multi-use court to the north of the new entry car park.	\$120,000	Medium	\$120,000	-
14	New planting including trees and shrubs to main entry, playspace surrounds and general reserve area.	\$75,000	Short	\$75,000	-
15	Improvements to Bridge House (including a new sensory garden and refurbishments to the building exteriors).	\$12,000	Short	\$12,000	-
Sub-Total		\$1,810,750		\$1,590,000	\$220,750

Precinct 2: Eastern Activity Area

The Eastern Activity Area and aims to provide more opportunities for general recreation use and dedicated dog off-leash area. A series of public art opportunities will provide visual connection, intrigue and wayfinding for park users, and the dedicated dog off-leash area to the east will remove conflict with users of the oval.

LEGEND

Short term	1-3 years
Medium term	4-6 years
Long term	7-10 years



Reference	Recommendations	Estimate Cost	Time Frame	Council/Other Contribution	State Govt. Contribution
16	Drinking fountain with dog bowl attachments.	\$13,250	Short	-	\$13,250
17	Fencing to Durham Road side and other high risk sections of dog off-leash area.	\$50,000	Short	\$50,000	-
18	Vegetation around dog park including trees and shrubs to form a natural barrier to footpath and remove conflict between park users.	\$100,000	Short	\$100,000	-
19	Provide additional path link from eastern bus stop along Durham Road	Completed	-	-	-
20	Picnic shelter with tables and seating.	\$50,000	Medium	\$50,000	-
20	Additional picnic tables and seating opportunities.	\$10,000	Medium	\$10,000	-
21	Modified seating/wetland viewing area to replace existing amphitheatre (including earthworks).	\$75,000	Medium	\$75,000	-
22	Additional rubbish bins around the dog off leash area.	\$5,000	Short	\$5,000	-
23	New feature artworks around the wetland.	tbc	Long	tbc	-
24	Investigate opportunities for additional parking along Durham Road.	tbc	Short	tbc	-
Sub-Total		\$303,250		\$290,000	\$13,250

Precinct 3: Northern Activity Area

The Northern Activity Area will remain as the dedicated sporting area for the local football and cricket clubs. Upgrades will be made to the oval and its surrounds to better accommodate these uses.

LEGEND

Short term	1-3 years
Medium term	4-6 years
Long term	7-10 years

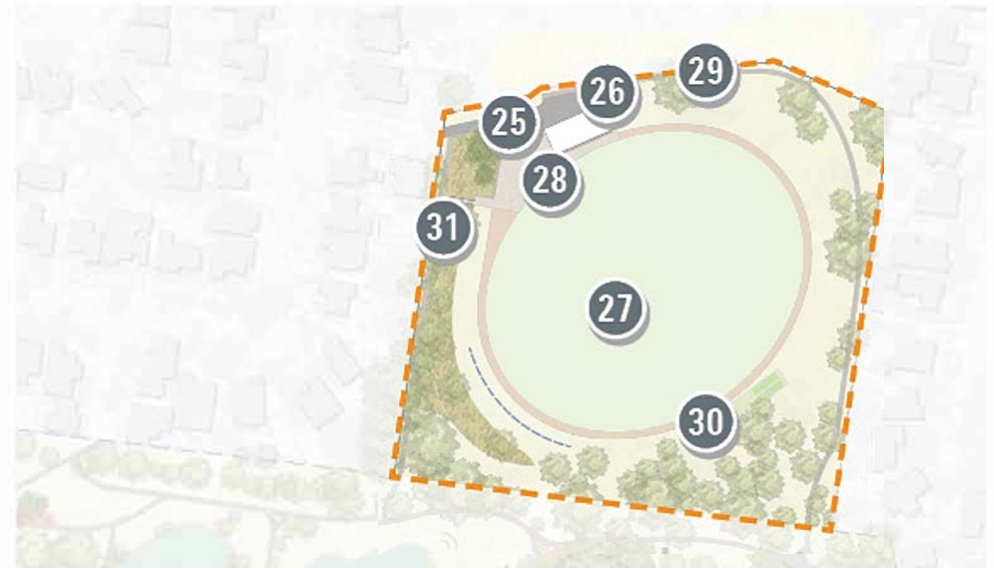

Reference	Recommendations	Estimate Cost	Time Frame	Council/Other Contribution	State Govt. Contribution
25	Establishment of services for new change facilities - power, water, sewerage	\$178,000	Completed	\$178,000	-
26	Provide prefabricated toilet/change facilities including all earthworks for emergency and disability vehicle access to the ground/club facilities.	\$424,000	Completed	\$84,000	\$340,000
27	Basic improvements to the playing surface - new turf.	\$50,000	Short	\$25,000	\$25,000
28	Drinking fountain.	\$13,250	Completed	\$2,250	\$11,000
29	Oval area landscaping and path works to connect with Reserve circuit.	\$50,000	Completed	\$25,000	\$25,000
30	Sports-ground conditions upgrade - including design, earthworks, drainage, turf, pitch works, cricket practice nets, goals, fences, gates and gravel paths.	\$1,400,000	Long	\$1,400,000	Future Application
30	Sport-ground lighting.	\$225,000	Long	\$225,000	Future Application
31	Garden planting and retaining wall upgrade.	\$180,000	Medium	\$180,000	-
Sub-Total		\$2,520,250		\$2,119,250	\$401,000

Master Plan Total	\$4,874,250	\$4,174,250	\$700,000
--------------------------	--------------------	--------------------	------------------



APPENDIX

(P1) Activity Precinct - Artist Impression

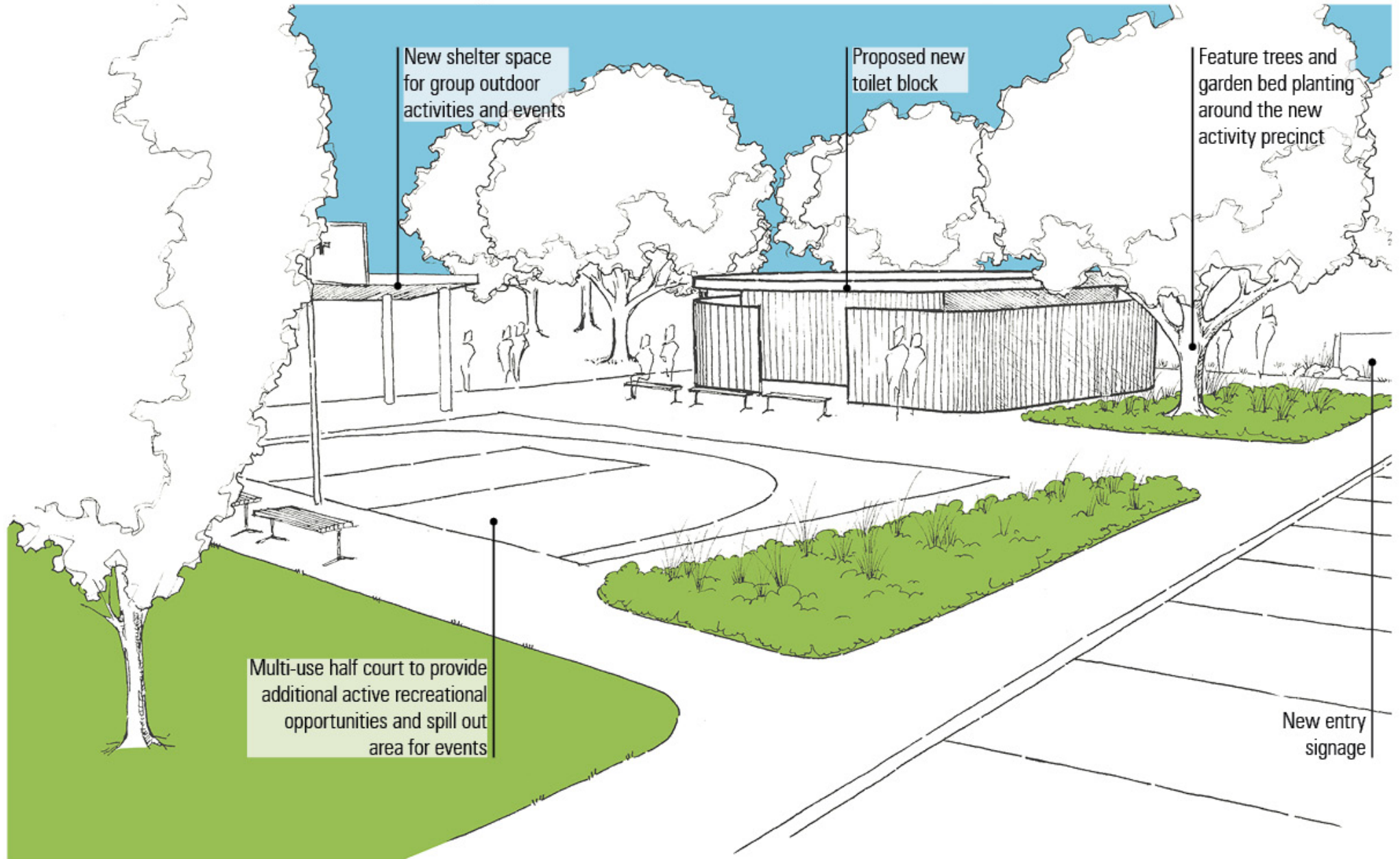

(P2) Board walk Lookout - Artist Impression

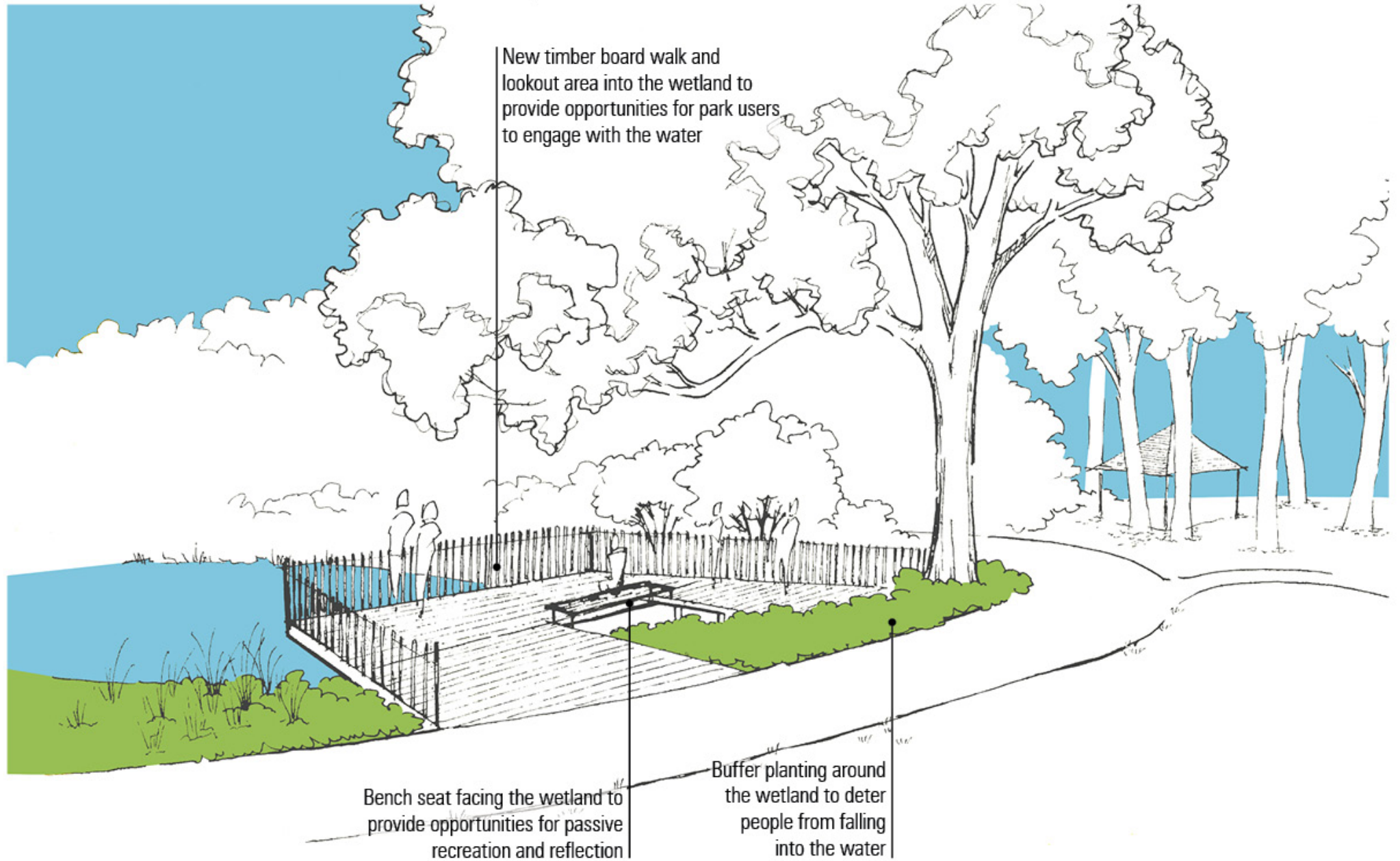

(P3) Grass Hill and Lookout - Artist Impression

