



Location

The Shire of Yarra Ranges is located in Melbourne's outer East. Its character changes from urban to rural and bush settings. The area of the 'Green Spine' Project is along Maroondah Highway from Brushy Creek near Croydon North Shopping Centre, to Manchester Road, next to Chirnside Park Shopping Centre.



Manchester Road Intersection



View along Maroondah Highway to Readings Cinema's

Gateway

Entry into the Shire of Yarra Ranges along Maroondah Highway presents a hot, fast, semi-barren road-scape. This project is designed to create a welcoming gateway to the Shire of Yarra Ranges through a concept of the 'Green Spine'.

The 'Green Spine' Concept

The concept aims to be sustainable in function and appearance through the introduction of key elements including

- Water Sensitive Urban Design -see notes below;
- Diverse planting of indigenous and native species and creation of habitat;
- Shading of hard surfaces through tree planting;
- Implementation of a shared path along the entire length and on both sides of the highway;
- Solar lighting designed to minimise light pollution to the sky; and
- Integrated public art and landscape -see notes on next sheet.



Proposed Concept Plan for the Green Spine -Maroondah Highway from Brushy Creek to Manchester Road

Site Analysis and Constraints

The site has been looked at carefully from a technical view. Constraints include underground and above ground services, drainage, VicRoads safety guidelines, sightlines to traffic and businesses, bus stops, lighting, floodlines, existing topography and vegetation, etc. These have been incorporated into the plan.



3 Dimensional Spaces

Once the constraints have been mapped, we are able to see the available space for landscape treatments.

This image shows where low planting and landform could occur (red shade), and the zone where taller trees can be planted (green shade).



Water Sensitive Urban Design (WSUD)

The project is investigating how we can use the water run-off from roads to passively irrigate our planting zones. An important part of this project is to clean the water from pollutants, like oil and petrol from the road environment. This treated water is then fit to be carried into our creeks and rivers, promoting healthy habitats and recreational areas.

Melbourne Water is contributing some funds to help this treatment. They are also investing in our Shire by providing education and training so that these treatments can occur throughout the entire Shire of Yarra Ranges.



Chirnside Park Major Activity Centre



Water Sensitive Urban Design (WSUD)
A typical image of planting in a raingarden.



Integrated art and landscape
An artistic impression of possible integrated art and landscape, showing the shared path moving through a cutting, besides WSUD planting.



Integrated art and landscape
An image of possible integrated art and landscape, showing the shared path moving along side a constructed room and WSUD.

Public Arts Strategy: The Concept of Home

Questions of home, house, dwelling and place underpin the Public Art Strategy and form the basis of its integration with the Landscape Architecture. Indeed, it could be seen to frame the overall approach to the Chimside Park Green Spine Project.

In this way, the Public Art Strategy conceives of the Green Spine Project as an act of place making. This is a work which configures a 1.8 kilometre corridor of passage as home, as a place of tarrying and transience, of homecoming and leave taking, a place of pride and pleasure, and above all, a place which, by engaging with the lives, hopes and dreams of the Shires' residents, contributes to civic dialogue.

What is this home then? The Public Art Strategy configures this home as an ensemble of 'rooms' distributed along the entire length of the project. Each of these 'rooms' can be understood simultaneously as an expression of home-making, and as a spatial fragment of an overall 'house'.

Charles Anderson, June 2009

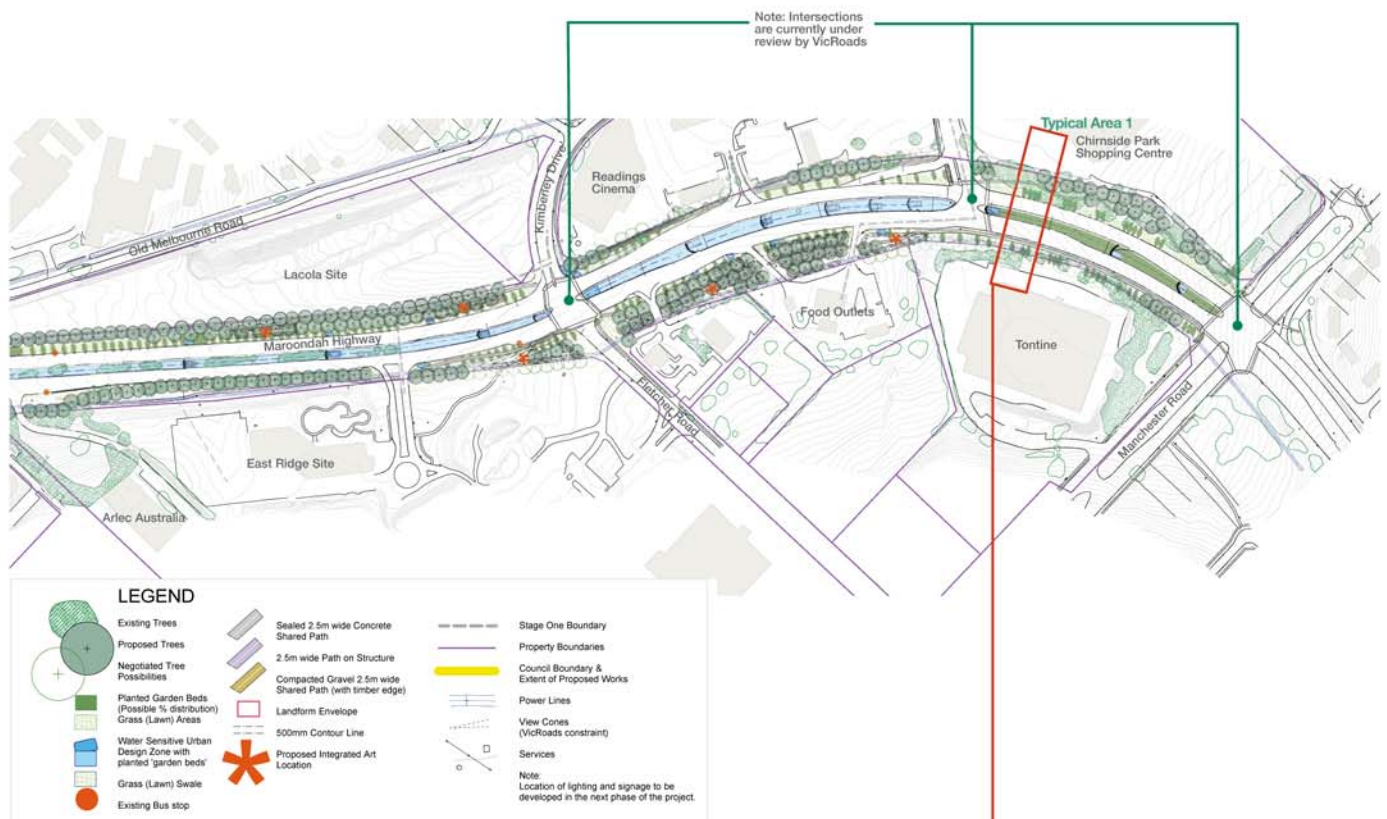

Typical Area 1 - Chimside Park and Tontine

Green Spine Project



ASPECT Studios

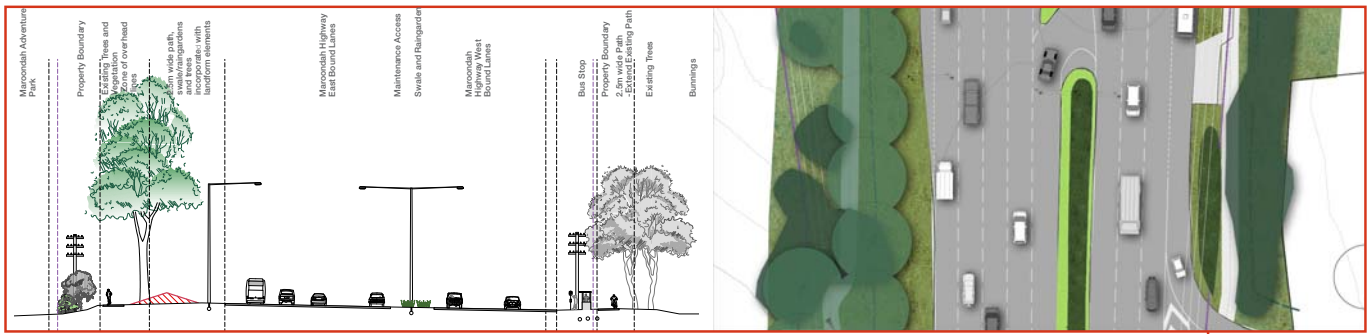

Typical Area 4 - Maroonah Adventure Park and Bunnings

West View towards Croydon North Shopping Centre and Dorset Road
 These views illustrate the potential for boulevard tree planting and Water Sensitive Urban Design throughout the median strip and on the edges of the road. It also shows the recreational path on both sides of the highway (maybe hidden by tree planting) and small changes to landform



Chirnside Park Major Activity Centre



Proposed East View towards Chirnside Park Shopping Centre and Manchester Road

