

Yarra Ranges Council Exhibitions and Creative Pathway Program Information Pack 2026



Contents

Introduction	Pg. 3
How to Apply	Pg. 3
What's Included in the ECPP Program	Pg. 4
Fees	Pg. 5
Selection Criteria	Pg. 5
Support	Pg. 6
Exhibition Information	
Installation	Pg. 6
Access / Staffing	Pg. 7
Artwork Sales	Pg. 7
Insurance	Pg. 7
Security	Pg. 7
Production Meetings	Pg. 8
Marketing & Promotion	Pg. 8
Artwork Labels	Pg. 8
Opening/Closing Event	Pg. 8
Terms & Conditions	Pg. 8 - 9
Venues	
The Memo Healesville	Pg. 10 - 11
Arts Centre Warburton	Pg. 12 - 13



Exhibitions and Creative Pathways Program Information Pack

Introduction

This document will provide artists with information about exhibiting as part of the *Exhibitions and Creative Pathways Program* (ECPP) with Yarra Ranges Council (Council). Consisting of two galleries, these vibrant spaces adhere to the curatorial aims below:

The Exhibitions and Creative Pathways Program supports and develops extraordinary creative output in the region, which in turn fosters a strong sense of local identity and encourages meaningful participation from community members.

The ECPP plays an integral role in the delivery of the Creative Communities Strategy at Yarra Ranges Council. Through it, we promote the Yarra Ranges as a vibrant arts hub that thrives economically, attracts creative people and embeds creativity within the cultural life of the region.

Please read the following document carefully as it is the main source for information needed to participate in the ECPP.

The preferred method for applying to the ECPP for 2026 is via our online form available from www.culturetracks.info.

If you require assistance or an alternative method of application, please contact the Regional Exhibitions Officer at exhibitions@yarraranges.vic.gov.au.

What is the Exhibitions and Creative Pathways Program (ECPP)?

This program will offer opportunity for emerging and mid-career Yarra Ranges artists seeking to progress their career and further develop their creative practice through mentoring and development of new work to deliver exceptional exhibition outcomes.

You are invited to submit proposals that can include, but are not limited to:

- Community engagement and interactive artworks
- Exhibition outcomes
- Residencies within the gallery spaces at our cultural venues
- Workshops and public programs
- Collaborations

We are interested in proposals which offer a way of activating the gallery spaces in our cultural venues or have the potential to connect with other events and community priorities.



What's included in the ECCP Program?

- An 8-10 week exhibition at either Arts Centre Warburton or The Memo, Healesville
- Professional mentorship and guidance from the Regional Exhibitions Officer (REO) in delivering a project/exhibition
- An exhibition opening or closing event
- The ability to host x1 ticketed program/event/activation (with in-kind venue hire), such as a:
 - Workshop
 - Artist talk
 - Book launch
 - School holiday program
 - Lecture
 - Performance
 - Screening
 - Panel discussion
 - Residency
- A marketing campaign
- Professional installation
- No exhibition fees or commission on sales (all sales must go directly through the exhibiting artist)
- Exhibition review & letter of support from the REO (if required)

Please Note:

1. Our cultural venues are multipurpose spaces and will be used by the community throughout the duration of the exhibition period. Exclusivity cannot be guaranteed, and availability of the Studio (Arts Centre Warburton) and Gallery (The Memo) for additional programming must be discussed with the Regional Exhibitions Officer and Venue Activation team.
2. At times, exhibition space availability will vary in duration. The exhibition spaces are closed on public holidays and at times, might be closed at the Council's discretion. This may impact the number of days an exhibition is open to the public.
3. Artists will retain the revenue from ticket sales for workshops and events associated with their exhibition, subject to a deduction of the online booking fee.



Fees

Please note the following regarding payments and charges:

- Successful artists will be offered exhibition space free of charge for the duration allocated.
- Council are not able to offer an artist fee.
- Council are not able to fund additional programming.
- Council do not take commission on sale of artworks (sales must be managed by the artist, see *Art Sales* section for more information)

Selection Criteria

Anyone who lives, works or plays in the Yarra Ranges can apply to participate in this initiative, but priority will be given to exhibitions / activations that:

- Present a coherent body of work of high visual and conceptual quality that articulates a theme, idea, premise, narrative, historical or contemporary issue.
- Give representation to:
 - Aboriginal and Torres Strait Islander artists and communities
 - LGBTIQA+ artists
 - Creatives who identify as neurodivergent, or have a lived experience of mental or physical illness or disability
- Contribute to a program which achieves overall balance of gender equity, cultural and linguistic diversity and engages a broad age range.
- Demonstrate strong audience engagement, community focus.
- May be experimental, innovative and have not been shown before.
- Are funded through the YRC Annual Grants Program
- Clearly demonstrate how the artist would use this opportunity to progress or develop their art practice.

Proposals will be assessed by a professional selection panel. Please be aware that we receive a high number of applications and that we are only able to support a very limited number of exhibitions.

Successful artists will be notified by mid-November 2025, with the program commencing in Mar/Apr 2026.



Exhibition Support

The REO provides a range of support to exhibiting artists including:

- Assistance with exhibition development and design
- Professional installation of artwork
- Design and installation of exhibition signage including wall texts, labels and a room sheet
- Access to exhibition spaces during venue operating hours
- Use of the following equipment:
 - Audio-visual equipment including projection
 - Sound system for the opening event or during the exhibition
 - Access to a variety of plinths, movable walls and suspension capabilities

Additional assistance available if requested:

- Professional development sessions
- Networking opportunities
- Support in planning and developing a public program/event
- Grant writing support

Exhibition Information

Installation

- The REO will install the exhibition with assistance from YRC technical officers.
- There are a variety of plinths available for display purposes – **there are no lockable display cabinets available.**
- Our hanging system consists of tracks, wires and hooks. A visit to the space is recommended. **No pins, screws or nails, including stick-on hooks are allowed to be used on the walls.**
- Access to audio-visual equipment including DVD players, media players, sound system, digital projectors and televisions can be provided subject to availability.
- The exhibition spaces cannot be painted for an exhibition. While we have the capacity to patch and paint over small holes the colour cannot be altered from white.
- Artists are required to pack and transport their artwork to and from the venue on the agreed upon date. **All transport costs (including insurance during transit) are to be covered by the artist.**
- All artwork must come prepared for installation (detailed instructions will be provided to successful candidates).
- Artists are required to pack down their exhibition within opening hours. If needed, the REO may assist the exhibitor. Please discuss deinstall in the production meeting. If ladders and special equipment is needed, a Council staff member must assist.



Access / Staffing

- **Access to exhibition spaces is only available during venue opening hours**
 - For a detailed list of opening hours please visit:
<https://www.yarraranges.vic.gov.au/Explore-Yarra-Ranges/Arts-and-our-creative-community/Cultural-venues/>

Council will staff the venue during opening hours. Artists are not permitted to enter the venue, or work on an exhibition outside of these hours. The opening event will take place within usual opening hours Council staff will be provided. Please note the exhibition spaces may be open outside of usual opening hours if another event is on in one of the venues.

Artwork Sales

Artwork sales are the responsibility of the artists, and Council will not act as artist agent or undertake responsibility for the sale of art works from the exhibition. We also take no commission on sales.

- Enquiries regarding the purchase of works will be referred to the artist or their agent. (Please advise the REO on the preferred method of contact for all sales enquiries).
- Artworks must not be removed from an exhibition prior to its closing date.
- The distribution of all sold works is the responsibility of the artist.
- As works are sold, artists *must* contact the REO to update them.

Insurance

Council provides insurance for artwork while it is being exhibited in our exhibition spaces. This cover is subject to the artworks being declared on Council's insurance policy (Fine Arts)

Further information on the insurance process will be provided to successful applicants.

Security

- Council venues have after-hours alarm protection and security.
- Please note that exhibition spaces are NOT invigilated inside the venues during opening hours, however venue staff may wander in and out of exhibition spaces as part of their front of house and customer service duties.



Production Meeting

Artists must attend a production meeting with the REO prior to their exhibition opening to discuss marketing, installation, insurance, etc. Meetings may be conducted in person, at the artist's studio, over the phone or on Microsoft teams.

It is likely that several production meetings will be required in the lead up to an exhibition opening.

Marketing and Promotion

All exhibitions in the ECPP program receive a customised marketing campaign, comprising of:

- An exhibition webpage (including mention of opening/closing event)
- Ticketing for an opening/closing event
- x1 event/workshop/activation webpage
- Ticketing for x1 event/workshop/activation
- Social media posts across @culturetracks platforms
- Mention in the culture tracks EDM
- Venue signage (including posters and digital screens)

Artists are encouraged to promote their exhibition as widely as possible. **A detailed list of marketing material requests and a timeline will be provided to successful applicants.**

Artwork Labels

A template will be emailed to the artist for completion. All information provided is final and no edits can be made after production.

Opening/Closing Event

Council will endeavour to support the artist to hold an opening or closing event at a time suitable for them. Opening/closing events must be within existing venue opening hours and the specific details of the opening will be discussed during the production meeting. Please note that the artist is required to supply their own catering and refreshments for an opening/closing event.

General Terms and Conditions

- All artists will be contacted on the status of their application at the end of the review period.
- All works in the exhibition must be original and created by the artist.
- The exhibition presented must relate to the original proposal submitted and approved. Council reserves the right to refuse installation if the exhibition deviates from the original proposal.



- Council will not permit the exhibition of works which are unfinished, deemed offensive/inappropriate for the space in which it is situated, or an OH&S risk to staff and/or public.

Questions and Assistance

If you have any questions relating to the Exhibitions and Creative Pathways Program, please contact the Regional Exhibitions Officer, Tyler Meredith at exhibitions@yarraranges.vic.gov.au.

The Memo Healesville

235 Maroondah Highway, Healesville

The Memo Gallery opened in 2011 and is owned and operated by the Yarra Ranges Council. The gallery is located in an exclusive exhibition space within The Memo, Healesville. It is centrally located in Healesville, has ample parking and is an accessible venue.

The space is a large white painted box, with floorboards. It is a professional looking gallery space suitable for contemporary artworks, as well as more traditional 2 and 3D artworks. It is an accommodating space that could be used for exhibitions, residencies, installations, projections and other ideas. It is frequented by the local community, movie and theatre goers, as well as tourists. A foyer is also available for hanging artwork, and may be used in conjunction with the Gallery, or as a smaller, secondary community hanging space.

FLOORPLAN

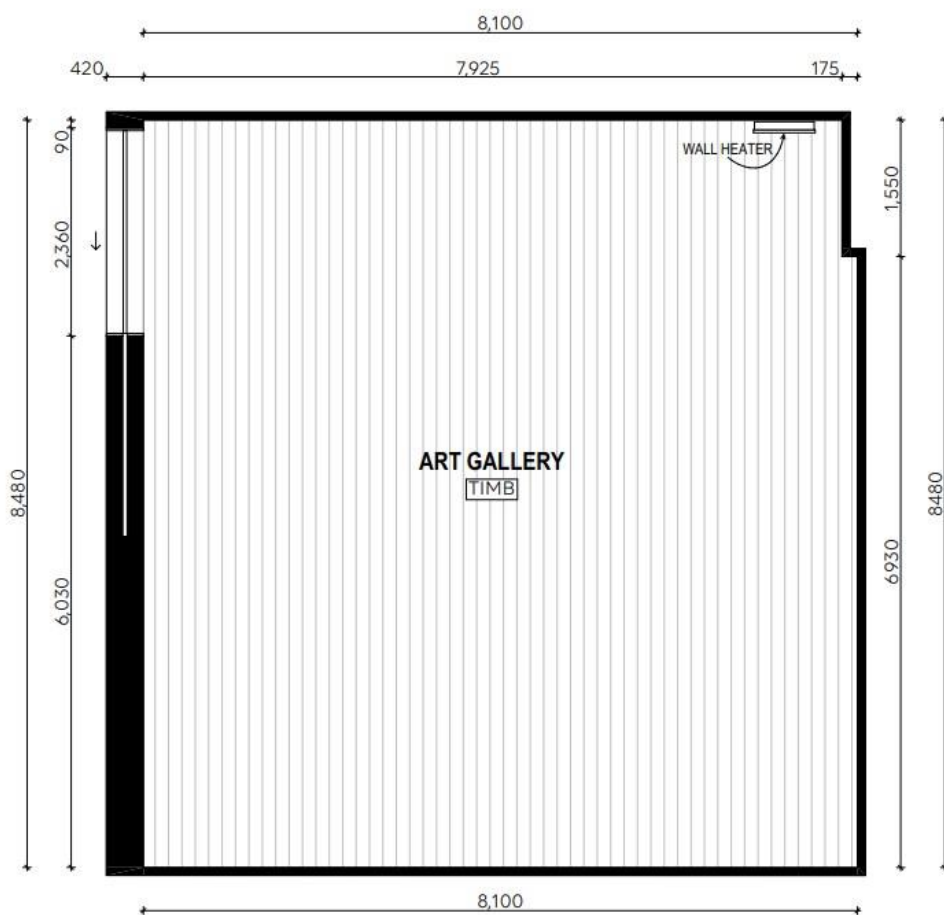

ART GALLERY FLOOR PLAN
SCALE: 1:50



CULTURE TRACKS

GALLERY SPECIFICATIONS

- 30m of wall space with a height of 3m
- Walls are fitted with a professional gallery hanging system
- Walls are white plasterboard
- Lighting will be completed by technical team and the Regional Exhibitions Officer to best highlight the artwork
- Data projector/s/TV are available to screen directly onto wall or screen
- Audio options are available – please discuss your requirements with gallery staff
- Various plinths, display cases and mannequins are available, please discuss with the REO

ACCESS

- The Memo is a public space, which is frequented by adults and children who may be in the building for other purposes
- It is located in the town Centre of Healesville, on the main street
- There are no admission charges to enter the exhibition
- The building is accessible to wheelchair users
- There is public parking located adjacent to the building
- Local public transport includes access to buses

The Studio, Arts Centre Warburton

3409 Warburton Highway, Warburton

The Studio opened in 2005 and is owned and operated by Council. The space is located in a multi-purpose exhibition space within the Arts Centre Warburton. It is centrally located in Warburton, has ample parking, and is an accessible venue.

The space is a large white painted box, with floor to ceiling windows at one end, letting light flood in from the 'river' end of the street. Frequented by a very creative local community, 'The Studio' is a space for exhibitions, events, residencies, installations and activations. A foyer is also available for hanging a small amount of artwork, and may be used in conjunction with The Studio, or as a smaller, secondary community hanging space.

FLOORPLAN

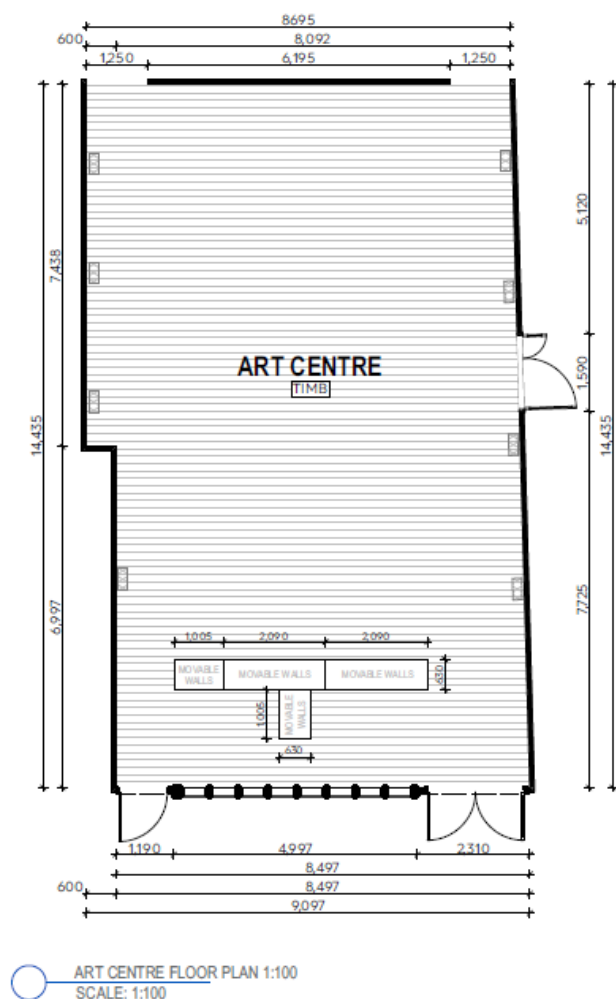

GALLERY SPECIFICATIONS

- 40m of wall space with heights between up to 3m.
- Walls are fitted with a professional gallery hanging system
- Walls are white brick
- Lights will be focussed by gallery staff to best display artwork
- Data projector available to screen directly onto wall or screen
- Audio options available – please discuss requirements with staff
- Various plinths, display cases and mannequins are available, please discuss with the REO
- Ceiling rigging for suspension of works
- Temporary walls are stored in the space and are usually utilised for exhibitions.

ACCESS

- The Arts Centre Warburton is a public space, which is frequented by adults and children who may be in the building for other purposes
- It is located in the town Centre of Warburton, on the main street
- There are no admission charges to enter the exhibition
- The building is accessible to wheelchair users
- There is public parking located adjacent to the building
- Local public transport includes access to buses

